

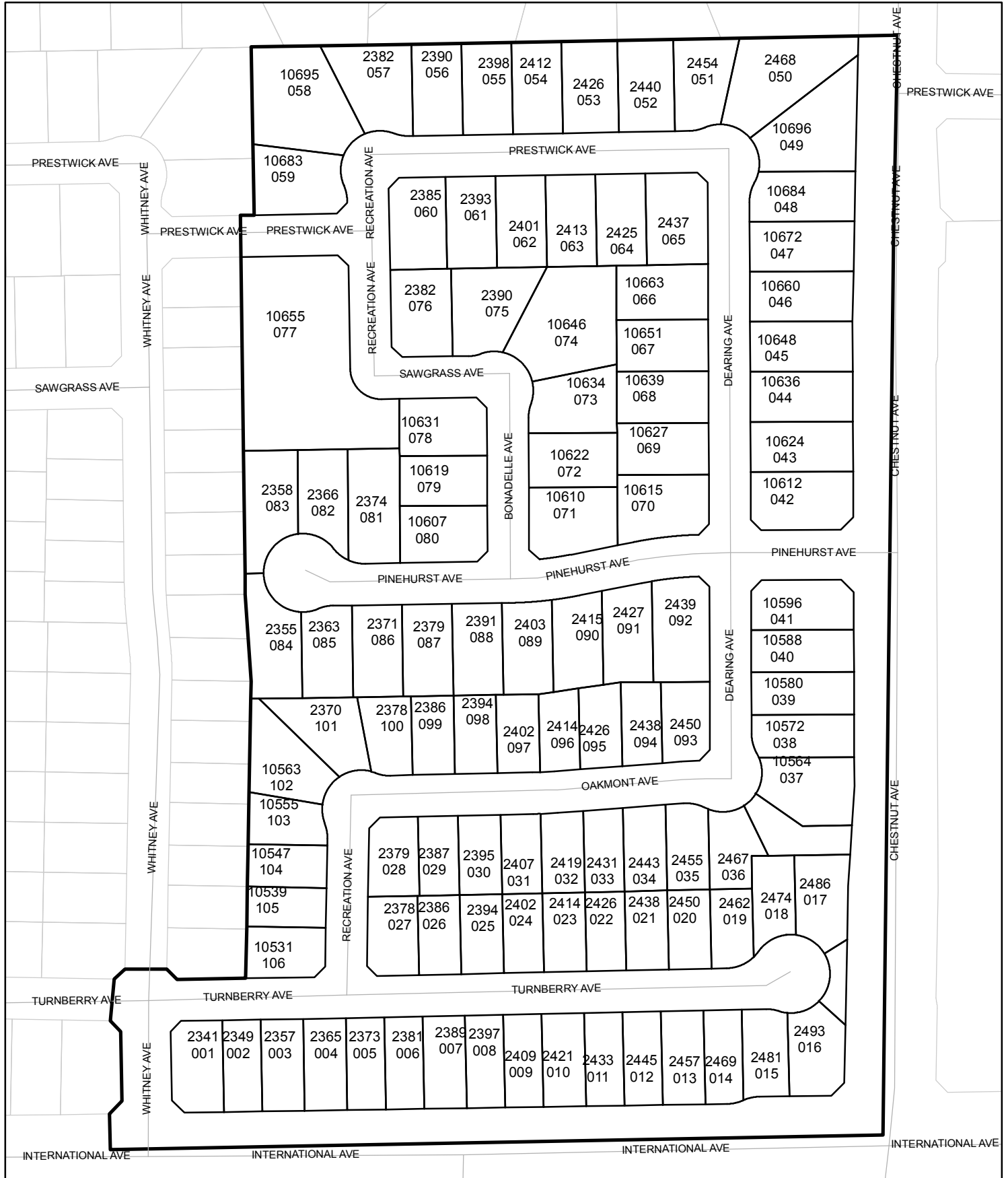

Street Names, Addresses and (Lot Numbers) for T5966

Prepared on Mon Oct 22 13:47:13 2018



TRACT NO. 5966

PHASE I OF VESTING TENTATIVE MAP NO. 5966

A PLANNED DEVELOPMENT

BEING A SUBDIVISION OF THE SOUTHEAST QUARTER OF THE NORTHWEST QUARTER OF SECTION 13, TOWNSHIP 12 SOUTH, RANGE 20 EAST, MOUNT DIABLO BASE AND MERIDIAN.

IN THE CITY OF FRESNO, COUNTY OF FRESNO, STATE OF CALIFORNIA SURVEYED AND PLATTED IN MARCH 2010, BY GARY G. GIANNETTA

CONSISTING OF TWO SHEETS SHEET TWO OF TWO SHEETS

BASIS OF BEARINGS

THE SOUTH LINE OF THE SOUTHEAST QUARTER OF THE NORTHWEST QUARTER OF SECTION 13, TOWNSHIP 12 SOUTH, RANGE 20 EAST, MOUNT DIABLO BASE AND MERIDIAN, TAKEN AS BEARING NORTH 88°35'09" EAST AS PER TRACT NO. 4903 RECORDED IN VOLUME 66 OF PLATS, AT PAGES 38 AND 39, INCLUSIVE, FRESNO COUNTY RECORDS.

NOTE:

1. SET 3/4" x 30" IRON PIPE, 6" DOWN, TAGGED RCE 26996 AT ALL LOT CORNERS AND ANGLE POINTS
2. OUTLOTS A AND B ARE DEDICATED IN FEE TO THE CITY OF FRESNO FOR OPEN SPACE AND PEDESTRIAN ACCESS PURPOSES SUBJECT TO CITY ACCEPTANCE OF DEVELOPER INSTALLED REQUIRED IMPROVEMENTS.
3. A PRIVATE IRRIGATION DITCH/PIPELINE RUNNING THROUGH PORTIONS OF SECTION 13 IS BEING RELOCATED AND SUBSTITUTED BY 24 INCH PIPELINE WITHIN A 8 OR 9 FOOT WIDE STRIP SHOWN HEREON.
4. OUTLOT C IS FOR FUTURE DEVELOPMENT

LEGEND:

- MONUMENT FOUND AND ACCEPTED AS NOTED
- SET 3/4" IRON PIPE, 30" LONG, 6" DOWN BELOW GROUND, TAGGED R.C.E. 26996
- ⊙ SET 3/4" IRON PIPE, 30" LONG, 4" UP IN 6" DIAMETER x 30" P.C.C. MONUMENT, DOWN 6" BELOW GROUND, TAGGED R.C.E. 26996
- ◇ SET 3/4" IRON PIPE, 30" LONG, 6" BELOW GROUND, TAGGED RCE 26996 AS SHOWN AT 3.00' FROM NEAREST LOT CORNERS. (DISTANCES SHOWN ARE TO TRUE LOT CORNER)
- ▲ NOW OFFERED FOR DEDICATION FOR PUBLIC STREET EASEMENT PURPOSES
- ▲▲▲▲ INDICATES RELINQUISHMENT OF DIRECT VEHICULAR ACCESS RIGHTS
- ▲▲▲▲ INDICATES RELINQUISHMENT OF DIRECT ACCESS RIGHTS
- () RECORD DATA AS PER TRACT NO. 4903, RECORDED IN VOLUME 66 OF PLATS, AT PAGES 38 AND 39, F.C.R.
- [] RECORD DATA AS PER TRACT NO. 4788, RECORDED IN VOLUME 60 OF PLATS, AT PAGES 52 THROUGH 56, F.C.R.
- { } RECORD DATA AS PER TRACT NO. 5229, RECORDED IN VOLUME 77 OF PLATS, AT PAGES 63 AND 64, F.C.R.
- △ PREVIOUSLY DEEDED FOR PUBLIC STREET PURPOSES PER DEED DOC. NO. 2006-0137732 RECORDED JUNE 30, 2006 F.C.R.
- △ PREVIOUSLY DEEDED FOR PUBLIC STREET PURPOSES PER DEED DOC. NO. 2008-0101824 RECORDED JULY 16, 2008 F.C.R.
- SDE 1 FRESNO METROPOLITAN FLOOD CONTROL DISTRICT STORM DRAIN EASEMENT, RECORDED *Sheet 22*, 2010 AS DOC. NO. 2010-0124316 F.C.R.
- SDE 2 FRESNO METROPOLITAN FLOOD CONTROL DISTRICT STORM DRAIN EASEMENT, RECORDED *Sheet 22*, 2010 AS DOC. NO. 2010-0124317 F.C.R.
- (R) DENOTES RADIAL BEARING TO CURVE
- CALC CALCULATED FROM RECORD DATA
- F.C.R. FRESNO COUNTY RECORDS
- PE PEDESTRIAN EASEMENT NOW OFFERED FOR DEDICATION FOR PUBLIC USE
- PPUE PLANTING AND PUBLIC UTILITY EASEMENT NOW OFFERED FOR DEDICATION FOR PUBLIC USE
- LE LANDSCAPE EASEMENT NOW OFFERED FOR DEDICATION FOR PUBLIC USE
- PUE PUBLIC UTILITY EASEMENT NOW OFFERED FOR DEDICATION FOR PUBLIC USE.
- M.D.B. & M. MOUNT DIABLO BASE & MERIDIAN
- BLUE BORDER INDICATES THE LIMITS OF THIS SUBDIVISION

MONUMENTS:

1. 3/4" IRON PIPE, DOWN 3", TAGGED RCE 19789 AS BEING THE NORTHWEST CORNER OF LOT 136 OF TRACT NO. 4432 AND 47.00' FROM THE SOUTH LINE OF THE NORTHWEST QUARTER OF SECTION 13
2. 3/4" IRON PIPE, DOWN 3", TAGGED RCE 19789 AS BEING THE NORTHEAST CORNER OF LOT 139 OF TRACT NO. 4432 AND 47.00' FROM THE SOUTH LINE OF THE NORTHWEST QUARTER OF SECTION 13
3. 3/4" IRON PIPE, DOWN 7", TAGGED RCE 19789 AS BEING AN ANGLE POINT ON THE NORTH LINE OF LOT 120 OF TRACT NO. 4788 AND 55.00' FROM THE SOUTH LINE OF THE NORTHWEST QUARTER OF SECTION 13

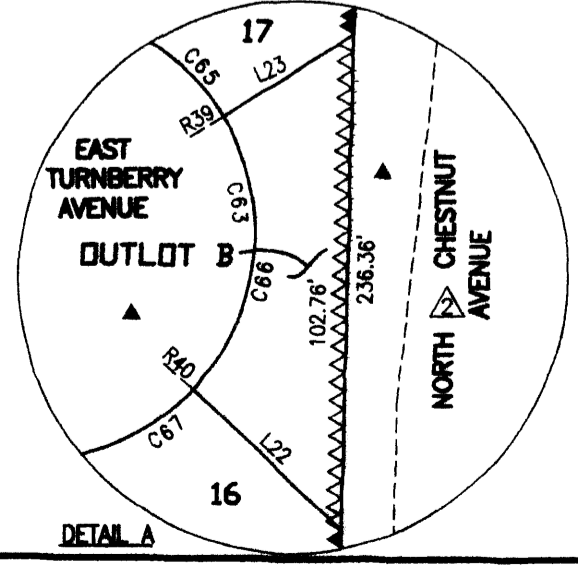

CURVE	DELTA	TANGENT	RADIUS	LENGTH
C1	22°07'57"	9.39	48.00	18.54
C2	134°15'54"	111.44	47.00	110.15
C3	45°18'25"	19.62	47.00	37.17
C4	44°52'10"	19.41	47.00	36.81
C5	44°05'19"	19.03	47.00	36.17
C6	22°07'57"	9.39	48.00	18.54
C7	22°07'57"	9.39	48.00	18.54
C8	142°02'55"	136.69	47.00	116.53
C9	23°54'07"	9.95	47.00	19.61
C10	48°45'44"	21.30	47.00	40.00
C11	52°16'16"	23.06	47.00	42.88
C12	17°06'48"	7.07	47.00	14.04
C13	29°06'38"	12.46	48.00	24.39
C14	18°40'18"	7.89	48.00	15.64
C15	128°08'56"	96.68	47.00	105.13
C16	33°13'11"	14.02	47.00	27.25
C17	63°13'38"	28.93	47.00	51.87
C18	31°42'07"	13.34	47.00	26.01
C19	18°40'18"	7.89	48.00	15.64
C21	52°22'21"	23.60	48.00	43.88
C22	25°04'38"	10.68	48.00	21.01
C23	27°17'43"	11.65	48.00	22.87
C24	254°30'18"	61.80	47.00	208.77
C25	58°09'01"	26.13	47.00	47.70
C26	84°02'11"	42.35	47.00	68.94
C27	86°56'57"	44.56	47.00	71.32
C28	25°22'09"	10.58	47.00	20.81
C29	22°07'57"	9.39	48.00	18.54
C30	10°19'59"	40.69	450.00	81.16
C31	05°14'16"	19.44	425.00	38.85
C32	10°19'59"	42.95	475.00	85.67
C33	06°15'31"	25.97	475.00	51.89
C34	04°04'28"	16.90	475.00	33.78
C35	11°00'12"	43.34	450.00	86.42
C36	09°29'44"	39.45	475.00	78.72
C37	09°19'05"	34.64	425.00	69.12
C38	22°07'57"	9.39	48.00	18.54
C39	131°59'25"	105.54	47.00	108.28
C40	28°25'21"	11.90	47.00	23.22
C41	48°45'45"	21.30	47.00	40.00
C42	48°45'44"	21.30	47.00	40.00
C43	06°02'35"	2.48	47.00	4.96
C44	22°07'56"	9.39	48.00	18.54
C45	03°10'45"	13.88	500.00	27.74
C46	03°10'45"	13.18	475.00	26.36
C47	01°05'08"	4.50	475.00	9.00
C48	02°05'37"	8.68	475.00	17.36
C49	03°10'45"	14.57	525.00	29.13
C50	00°58'38"	4.25	525.00	8.50
C51	02°15'07"	10.32	525.00	20.63
C52	31°23'22"	13.49	48.00	26.30
C53	146°19'44"	155.32	47.00	120.03
C54	05°04'22"	2.08	47.00	4.16
C55	54°55'09"	24.42	47.00	45.05
C56	24°32'55"	10.23	47.00	20.14
C57	55°01'03"	24.48	47.00	45.13
C58	06°46'15"	2.78	47.00	5.55
C59	29°06'37"	12.46	48.00	24.39
C60	53°52'50"	24.39	48.00	45.13
C61	43°14'23"	19.02	48.00	36.22
C62	10°38'27"	4.47	48.00	8.91
C63	252°33'08"	64.04	47.00	207.17
C64	62°37'18"	28.59	47.00	51.37
C65	51°12'02"	22.52	47.00	42.00
C66	74°36'15"	35.81	47.00	61.20
C67	51°12'02"	22.52	47.00	42.00
C68	12°55'31"	5.32	47.00	10.60
C69	18°40'18"	7.89	48.00	15.64
C70	23°04'26"	10.21	50.00	20.14
C71	23°04'26"	10.21	50.00	20.14
C72	00°33'58"	0.25	50.00	0.50
C73	22°30'28"	9.95	50.00	19.64
C74	01°37'53"	6.05	425.00	12.10
C75	07°41'12"	28.55	425.00	57.02
C76	03°10'45"	13.88	500.00	27.74
C77	02°24'26"	11.03	525.00	22.06
C78	90°00'00"	37.00	37.00	58.12

LINE	DIRECTION	DISTANCE
L1	N 43°27'02" E	17.68
L2	N 43°27'02" E	17.68
L3	N 46°32'58" W	17.88
L4	N 46°08'48" W	17.55
L5	N 46°32'58" W	17.68
L6	N 46°08'48" W	17.55
L7	N 43°55'16" E	17.78
L8	N 48°12'25" W	16.87
L9	N 43°52'45" E	17.79
L10	N 46°09'54" W	17.55
L11	N 45°44'38" W	17.68
L12	N 44°15'22" E	17.68
L13	N 44°24'06" E	18.03
L14	N 43°42'56" E	17.84
L15	N 88°35'09" E	59.52
L16	N 55°45'37" W	68.16
L17	N 26°15'38" W	66.95
L18	N 46°24'51" W	21.21
L19	N 43°35'09" E	17.68
L20	N 44°33'44" E	17.98
L21	N 45°35'54" W	17.32
L22	N 47°31'58" W	42.98
L23	N 58°12'22" E	32.32
L24	N 44°38'13" E	21.60
L25	N 44°15'22" E	21.21
L26	N 45°44'38" W	21.21
L27	N 01°24'51" W	15.00
L28	S 01°44'08" E	17.00
L29	N 88°15'52" E	30.00
L30	N 88°46'18" E	22.21

RADIAL	DIRECTION
R1	N 66°19'05" E
R2	N 68°22'30" W
R3	N 23°30'20" W
R4	S 20°34'59" W
R5	S 23°40'55" W
R6	N 00°13'12" E
R7	N 48°58'56" E
R8	S 78°44'48" W
R9	S 61°38'00" W
R10	S 20°13'16" E
R11	N 12°59'55" E
R12	N 76°13'33" E
R13	N 72°04'20" W
R14	S 23°39'47" W
R15	S 50°57'30" W
R16	N 07°11'31" W
R17	S 88°46'18" W
R18	S 01°49'21" W
R19	N 23°32'48" W
R20	S 06°30'34" E
R21	S 07°40'22" E
R22	N 02°15'06" W
R23	N 02°25'45" W
R24	N 68°24'23" E
R25	N 83°10'16" W
R26	N 34°24'31" W
R27	N 14°21'13" E
R28	N 26°28'29" E
R29	S 21°24'07" W
R30	S 33°31'02" E
R31	S 58°03'57" E
R32	N 66°55'00" E
R33	S 60°08'45" W
R34	S 02°49'16" E
R35	S 02°39'46" E
R36	S 44°58'31" E
R37	N 55°36'58" W
R38	N 07°00'20" E
R39	S 58°12'22" E
R40	S 47°11'23" E
R41	S 04°00'39" W
R42	S 16°56'10" W
R43	S 24°29'17" W
R44	N 23°55'19" W
R45	S 01°24'51" E
R46	N 10°08'57" W
R47	N 02°30'27" W
R48	N 20°23'48" E

3/4" IRON PIPE, IN CONCRETE, DOWN 4", TAGGED RCE 26996 AS BEING SOUTHWEST CORNER OF LOT 59 OF TRACT NO. 4903 AND ON THE WEST LINE OF THE SOUTHWEST QUARTER OF SECTION 13 AND THE WEST LINE OF THE SOUTHWEST QUARTER OF SECTION 13

PREVIOUSLY DEEDED FOR PUBLIC STREET PURPOSES PER DEED DOC. NO. 2010-0087916 RECORDED JULY 9, 2010 F.C.R.

PREVIOUSLY DEEDED FOR PUBLIC STREET PURPOSES PER DEED DOC. NO. 95061335 RECORDED MAY 22, 1995 F.C.R.

3/4" IRON PIPE, DOWN 4", TAGGED RCE 26996 AS BEING SOUTHWEST CORNER OF LOT 57 OF TRACT NO. 4903 AND ON THE WEST LINE OF THE SOUTHWEST QUARTER OF SECTION 13

PREVIOUSLY DEEDED FOR PUBLIC STREET PURPOSES PER DEED DOC. NO. 2010-0087916 RECORDED JULY 9, 2010 F.C.R.

3/4" IRON PIPE, DOWN 4", TAGGED RCE 26996 AS BEING SOUTHWEST CORNER OF LOT 55 OF TRACT NO. 4903 AND ON THE WEST LINE OF THE SOUTHWEST QUARTER OF SECTION 13

PREVIOUSLY DEEDED FOR PUBLIC STREET PURPOSES PER DEED DOC. NO. 2010-0087916 RECORDED JULY 9, 2010 F.C.R.

3/4" IRON PIPE, IN CONCRETE, DOWN 4", TAGGED RCE 26996 AS BEING SOUTHWEST CORNER OF LOT 59 OF TRACT NO. 4903 AND ON THE WEST LINE OF THE SOUTHWEST QUARTER OF SECTION 13 AND THE WEST LINE OF THE SOUTHWEST QUARTER OF SECTION 13

PREVIOUSLY DEEDED FOR PUBLIC STREET PURPOSES PER DEED DOC. NO. 2010-0087916 RECORDED JULY 9, 2010 F.C.R.

PREVIOUSLY DEEDED FOR PUBLIC STREET PURPOSES PER DEED DOC. NO. 95061335 RECORDED MAY 22, 1995 F.C.R.

3/4" IRON PIPE, DOWN 4", TAGGED RCE 26996 AS BEING SOUTHWEST CORNER OF LOT 57 OF TRACT NO. 4903 AND ON THE WEST LINE OF THE SOUTHWEST QUARTER OF SECTION 13

PREVIOUSLY DEEDED FOR PUBLIC STREET PURPOSES PER DEED DOC. NO. 2010-0087916 RECORDED JULY 9, 2010 F.C.R.

3/4" IRON PIPE, DOWN 4", TAGGED RCE 26996 AS BEING SOUTHWEST CORNER OF LOT 55 OF TRACT NO. 4903 AND ON THE WEST LINE OF THE SOUTHWEST QUARTER OF SECTION 13

PREVIOUSLY DEEDED FOR PUBLIC STREET PURPOSES PER DEED DOC. NO. 2010-0087916 RECORDED JULY 9, 2010 F.C.R.

3/4" IRON PIPE, IN CONCRETE, DOWN 4", TAGGED RCE 26996 AS BEING SOUTHWEST CORNER OF LOT 59 OF TRACT NO. 4903 AND ON THE WEST LINE OF THE SOUTHWEST QUARTER OF SECTION 13 AND THE WEST LINE OF THE SOUTHWEST QUARTER OF SECTION 13

PREVIOUSLY DEEDED FOR PUBLIC STREET PURPOSES PER DEED DOC. NO. 2010-0087916 RECORDED JULY 9, 2010 F.C.R.

PREVIOUSLY DEEDED FOR PUBLIC STREET PURPOSES PER DEED DOC. NO. 95061335 RECORDED MAY 22, 1995 F.C.R.

3/4" IRON PIPE, DOWN 4", TAGGED RCE 26996 AS BEING SOUTHWEST CORNER OF LOT 57 OF TRACT NO. 4903 AND ON THE WEST LINE OF THE SOUTHWEST QUARTER OF SECTION 13

PREVIOUSLY DEEDED FOR PUBLIC STREET PURPOSES PER DEED DOC. NO. 2010-0087916 RECORDED JULY 9, 2010 F.C.R.

3/4" IRON PIPE, DOWN 4", TAGGED RCE 26996 AS BEING SOUTHWEST CORNER OF LOT 55 OF TRACT NO. 4903 AND ON THE WEST LINE OF THE SOUTHWEST QUARTER OF SECTION 13

PREVIOUSLY DEEDED FOR PUBLIC STREET PURPOSES PER DEED DOC. NO. 2010-0087916 RECORDED JULY 9, 2010 F.C.R.

3/4" IRON PIPE, IN CONCRETE, DOWN 4", TAGGED RCE 26996 AS BEING SOUTHWEST CORNER OF LOT 59 OF TRACT NO. 4903 AND ON THE WEST LINE OF THE SOUTHWEST QUARTER OF SECTION 13 AND THE WEST LINE OF THE SOUTHWEST QUARTER OF SECTION 13

PREVIOUSLY DEEDED FOR PUBLIC STREET PURPOSES PER DEED DOC. NO. 2010-0087916 RECORDED JULY 9, 2010 F.C.R.

PREVIOUSLY DEEDED FOR PUBLIC STREET PURPOSES PER DEED DOC. NO. 95061335 RECORDED MAY 22, 1995 F.C.R.

3/4" IRON PIPE, DOWN 4", TAGGED RCE 26996 AS BEING SOUTHWEST CORNER OF LOT 57 OF TRACT NO. 4903 AND ON THE WEST LINE OF THE SOUTHWEST QUARTER OF SECTION 13

PREVIOUSLY DEEDED FOR PUBLIC STREET PURPOSES PER DEED DOC. NO. 2010-0087916 RECORDED JULY 9, 2010 F.C.R.

3/4" IRON PIPE, DOWN 4", TAGGED RCE 26996 AS BEING SOUTHWEST CORNER OF LOT 55 OF TRACT NO. 4903 AND ON THE WEST LINE OF THE SOUTHWEST QUARTER OF SECTION 13

PREVIOUSLY DEEDED FOR PUBLIC STREET PURPOSES PER DEED DOC. NO. 2010-0087916 RECORDED JULY 9, 2010 F.C.R.

3/4" IRON PIPE, IN CONCRETE, DOWN 4", TAGGED RCE 26996 AS BEING SOUTHWEST CORNER OF LOT 59 OF TRACT NO. 4903 AND ON THE WEST LINE OF THE SOUTHWEST QUARTER OF SECTION 13 AND THE WEST LINE OF THE SOUTHWEST QUARTER OF SECTION 13

PREVIOUSLY DEEDED FOR PUBLIC STREET PURPOSES PER DEED DOC. NO. 2010-0087916 RECORDED JULY 9, 2010 F.C.R.

PREVIOUSLY DEEDED FOR PUBLIC STREET PURPOSES PER DEED DOC. NO. 95061335 RECORDED MAY 22, 1995 F.C.R.

3/4" IRON PIPE, DOWN 4", TAGGED RCE 26996 AS BEING SOUTHWEST CORNER OF LOT 57 OF TRACT NO. 4903 AND ON THE WEST LINE OF THE SOUTHWEST QUARTER OF SECTION 13

PREVIOUSLY DEEDED FOR PUBLIC STREET PURPOSES PER DEED DOC. NO. 2010-0087916 RECORDED JULY 9, 2010 F.C.R.

3/4" IRON PIPE, DOWN 4", TAGGED RCE 26996 AS BEING SOUTHWEST CORNER OF LOT 55 OF TRACT NO. 4903 AND ON THE WEST LINE OF THE SOUTHWEST QUARTER OF SECTION 13

PREVIOUSLY DEEDED FOR PUBLIC STREET PURPOSES PER DEED DOC. NO. 2010-0087916 RECORDED JULY 9, 2010 F.C.R.

3/4" IRON PIPE, IN CONCRETE, DOWN 4", TAGGED RCE 26996 AS BEING SOUTHWEST CORNER OF LOT 59 OF TRACT NO. 4903 AND ON THE WEST LINE OF THE SOUTHWEST QUARTER OF SECTION 13 AND THE WEST LINE OF THE SOUTHWEST QUARTER OF SECTION 13

PREVIOUSLY DEEDED FOR PUBLIC STREET PURPOSES PER DEED DOC. NO. 2010-0087916 RECORDED JULY 9, 2010 F.C.R.

PREVIOUSLY DEEDED FOR PUBLIC STREET PURPOSES PER DEED DOC. NO. 95061335 RECORDED MAY 22, 1995 F.C.R.

3/4" IRON PIPE, DOWN 4", TAGGED RCE 26996 AS BEING SOUTHWEST CORNER OF LOT 57 OF TRACT NO. 4903 AND ON THE WEST LINE OF THE SOUTHWEST QUARTER OF SECTION 13

PREVIOUSLY DEEDED FOR PUBLIC STREET PURPOSES PER DEED DOC. NO. 2010-0087916 RECORDED JULY 9, 2010 F.C.R.

3/4" IRON PIPE, DOWN 4", TAGGED RCE 26996 AS BEING SOUTHWEST CORNER OF LOT 55 OF TRACT NO. 4903 AND ON THE WEST LINE OF THE SOUTHWEST QUARTER OF SECTION 13

PREVIOUSLY DEEDED FOR PUBLIC STREET PURPOSES PER DEED DOC. NO. 2010-0087916 RECORDED JULY 9, 2010 F.C.R.

3/4" IRON PIPE, IN CONCRETE, DOWN 4", TAGGED RCE 26996 AS BEING SOUTHWEST CORNER OF LOT 59 OF TRACT NO. 4903 AND ON THE WEST LINE OF THE SOUTHWEST QUARTER OF SECTION 13 AND THE WEST LINE OF THE SOUTHWEST QUARTER OF SECTION 13

PREVIOUSLY DEEDED FOR PUBLIC STREET PURPOSES PER DEED DOC. NO. 2010-0087916 RECORDED JULY 9, 2010 F.C.R.

PREVIOUSLY DEEDED FOR PUBLIC STREET PURPOSES PER DEED DOC. NO. 95061335 RECORDED MAY 22, 1995 F.C.R.

3/4" IRON PIPE, DOWN 4", TAGGED RCE 26996 AS BEING SOUTHWEST CORNER OF LOT 57 OF TRACT NO. 4903 AND ON THE WEST LINE OF THE SOUTHWEST QUARTER OF SECTION 13

PREVIOUSLY DEEDED FOR PUBLIC STREET PURPOSES PER DEED DOC. NO. 2010-0087916 RECORDED JULY 9, 2010 F.C.R.

3/4" IRON PIPE, DOWN 4", TAGGED RCE 26996 AS BEING SOUTHW