

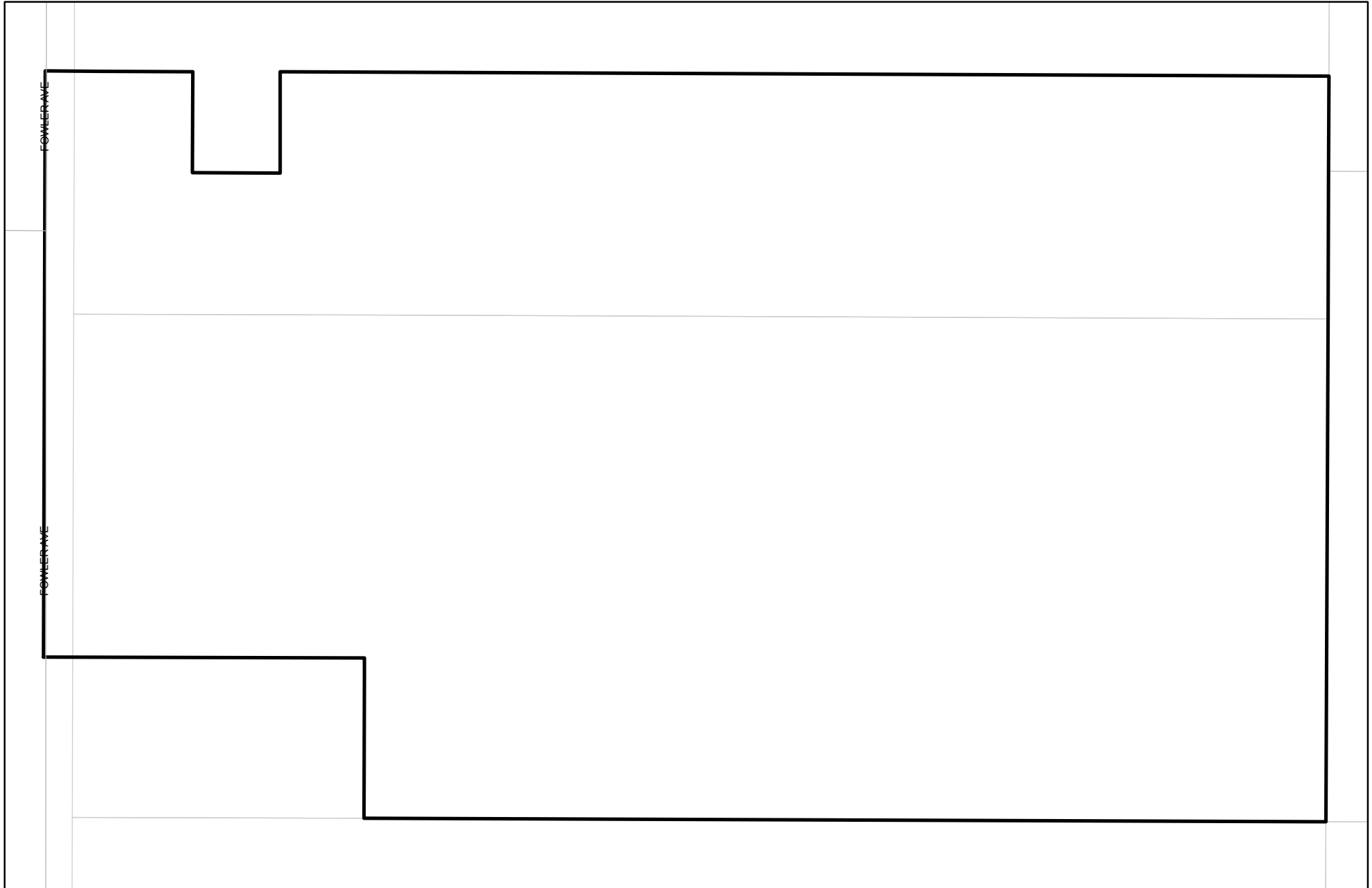

Prepared on Mon Oct 22 14:14:02 2018

Street Names, Addresses and (Lot Numbers) for T5552



TRACT NO. 5552

PHASE I OF TENTATIVE TRACT NO. 5552

IN THE CITY OF FRESNO
 FRESNO COUNTY, CALIFORNIA
 SURVEYED AND PLATTED IN NOVEMBER, 2006
 BY HARBOUR AND ASSOCIATES
 CONSISTING OF 3 SHEETS
 SHEET 2 OF 3

SEE SHEET 3 FOR CURVE, LINE AND
 RADIAL DATA TABLES



- LEGEND:**
- MONUMENT FOUND AND ACCEPTED AS DESCRIBED HEREON UNLESS OTHERWISE NOTED.
 - () INDICATES RECORD DATA PER RECORD OF SURVEY RECORDED IN BOOK 48 OF RECORD OF SURVEYS, AT PAGE 69, FRESNO COUNTY RECORDS.
 - < > INDICATES RECORD DATA PER RECORD OF SURVEY RECORDED IN BOOK 40 OF RECORD OF SURVEYS, AT PAGE 68, FRESNO COUNTY RECORDS.
 - [] INDICATES RECORD DATA PER PARCEL MAP No. 7652 RECORDED IN BOOK 57 OF PARCEL MAPS, AT PAGE 93, FRESNO COUNTY RECORDS.
 - { } INDICATES RECORD DATA PER PARCEL MAP No. 3106 RECORDED IN BOOK 21 OF PARCEL MAPS, AT PAGE 52, FRESNO COUNTY RECORDS.
 - (()) INDICATES RECORD DATA PER DOCUMENT NO. 2003-0271365 RECORDED NOVEMBER 7, 2003, OFFICIAL RECORDS OF FRESNO COUNTY.
 - ▲ INDICATES NOW OFFERED FOR DEDICATION FOR PUBLIC STREET AND UTILITY PURPOSES.
 - ▲ INDICATES PREVIOUSLY DEDICATED FOR PUBLIC STREET AND UTILITY PURPOSES AS NOTED HEREON.
 - ||||| INDICATES WAIVER OF DIRECT VEHICULAR ACCESS RIGHTS.
 - PUE PUBLIC UTILITY EASEMENT NOW OFFERED FOR DEDICATION FOR PUBLIC USE.
 - PE PEDESTRIAN EASEMENT NOW OFFERED FOR DEDICATION FOR PUBLIC USE.
 - LE LANDSCAPE EASEMENT NOW OFFERED FOR DEDICATION FOR PUBLIC USE.

BASIS OF BEARINGS:
 THE WEST LINE OF THE SOUTHWEST QUARTER OF SECTION 15, 14/21, M.D.B.&M., WAS TAKEN TO BE NORTH 00°14'30" WEST, AS SHOWN ON RECORD OF SURVEY RECORDED IN BOOK 40 OF RECORD OF SURVEYS AT PAGE 68, FRESNO COUNTY RECORDS.

- NOTES:**
1. 3/4" x 30" IRON PIPE, DOWN 0.5', TAGGED LS 5277 SET AT ALL LOT CORNERS, BLOCK CORNERS AND BEGINNING AND ENDING OF ALL CURVES, OR WILL BE SET WITHIN ONE YEAR OR ANY APPROVED EXTENSION THEREOF.
 2. ALL DISTANCES NOT MONUMENTED ARE CALCULATED

