

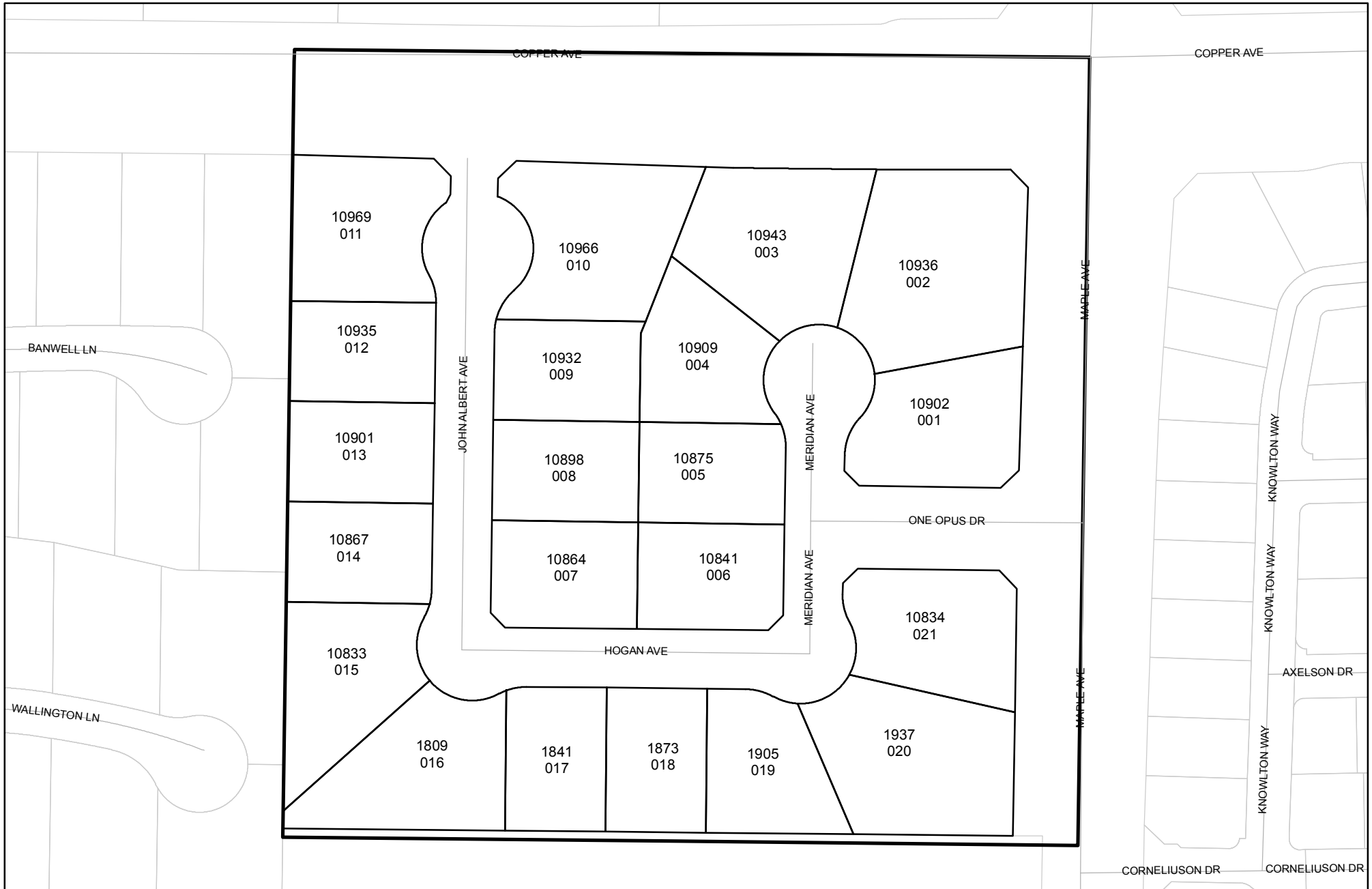

Prepared on Tue Feb 07 23:20:03 2017

Street Names, Addresses and (Lot Numbers) for T5261



TRACT NO. 5261

IN THE CITY OF FRESNO, COUNTY OF FRESNO, STATE OF CALIFORNIA

SURVEYED AND PLATTED IN JUNE, 2004 BY GARY G. GIANNETTA

CONSISTING OF TWO SHEETS

SHEET TWO OF TWO SHEETS



SCALE: 1" = 100'

BASIS OF BEARINGS

THE EAST LINE OF THE NORTHEAST QUARTER OF SECTION 14, TOWNSHIP 12 SOUTH, RANGE 20 EAST, M.D.B. & M. TAKEN AS BEARING NORTH 0°23'20" EAST AS PER TRACT NO. 5260, RECORDED IN VOLUME 70, PAGES 63 AND 64 OF PLATS, FRESNO COUNTY RECORDS.

LEGEND:

- MONUMENT FOUND AND ACCEPTED AS NOTED
- SET 3/4" IRON PIPE, 30" LONG, 6" DOWN BELOW GROUND, TAGGED R.C.E. 26996
- ⊙ SET 3/4" IRON PIPE, 30" LONG, 4" UP IN 6" DIAMETER x 30" P.C.C. MONUMENT, DOWN 6" BELOW GROUND, TAGGED R.C.E. 26996
- ▲ NOW OFFERED FOR DEDICATION FOR PUBLIC STREET PURPOSES
- △ PREVIOUSLY DEEDED FOR PUBLIC STREET PURPOSES OCT. 31, 1902 IN VOLUME 219 PAGE 239 OF DEEDS, F.C.R.
- △ PREVIOUSLY DEEDED FOR PUBLIC STREET PURPOSES MAR. 20, 1905 AS DOC. NO. 338 IN VOLUME 321, PAGE 346 OF DEEDS, F.C.R.
- △ PREVIOUSLY DEDICATED FOR PUBLIC STREET PURPOSES AS PER PARCEL MAP NO. 2673, RECORDED IN BOOK 17, PAGE 53 OF PARCEL MAPS, F.C.R.
- △ PREVIOUSLY DEEDED FOR PG&E PURPOSES JULY 15, 2004 AS DOCUMENT NO. 2004-0154283, F.C.R.
- ▲▲▲▲ INDICATES RELINQUISHMENT OF DIRECT ACCESS RIGHTS
- △△△△ INDICATES RELINQUISHMENT OF DIRECT VEHICULAR ACCESS RIGHTS
- () RECORD DATA AS PER TRACT NO. 5260, RECORDED IN VOLUME 70, PAGES 63 AND 64 OF PLATS, F.C.R.
- { } RECORD DATA AS PER TRACT NO. 5010, RECORDED IN VOLUME 70, PAGES 5 AND 6 OF PLATS, F.C.R.
- (()) RECORD DATA AS PER TRACT NO. 5101, RECORDED IN VOLUME 69, PAGES 82, 83 & 84 OF PLATS, F.C.R.
- { } RECORD DATA AS PER TRACT NO. 5110, RECORDED IN VOLUME 68, PAGES 82 AND 83 OF PLATS, F.C.R.
- [] RECORD DATA AS PER PARCEL MAP NO. 2673 RECORDED IN BOOK 17, PAGE 53 OF PARCEL MAPS, F.C.R.
- F.C.R. FRESNO COUNTY RECORDS
- LE LANDSCAPE EASEMENT NOW OFFERED FOR DEDICATION FOR PUBLIC USE
- PE PEDESTRIAN EASEMENT NOW OFFERED FOR DEDICATION FOR PUBLIC USE
- PUE PUBLIC UTILITY EASEMENT NOW OFFERED FOR DEDICATION FOR PUBLIC USE
- PPUE PLANTING AND PUBLIC UTILITY EASEMENT NOW OFFERED FOR DEDICATION FOR PUBLIC USE
- (CALC) CALCULATED FROM RECORD DATA
- (R) DENOTES RADIAL BEARING
- BLUE BORDER INDICATES THE LIMITS OF THIS SUBDIVISION

NOTE:

1. SET 3/4" IRON PIPE, 6" DOWN, TAGGED RCE 26996 AT ALL LOT CORNERS

RADIAL	DIRECTION
R1	N 60°51'03" E
R2	N 35°24'41" W
R3	N 20°36'29" E
R4	N 41°27'17" W
R5	N 76°40'51" W
R6	N 65°36'52" E
R7	N 52°56'44" E
R8	N 46°06'33" W
R9	N 18°30'03" E
R10	N 83°06'39" E
R11	N 47°35'43" W
R12	S 75°12'27" E
R13	N 60°33'58" W
R14	S 49°25'06" W
R15	N 29°02'25" W
R16	N 20°30'46" W
R17	N 29°10'50" E
R18	S 02°34'39" W
R19	S 62°01'57" E
R20	N 61°12'48" E
R21	S 00°20'30" W
R22	S 00°37'01" E
R23	S 00°09'13" E

LINE	DIRECTION	DISTANCE
L1	N 43°54'02" W	20.65'
L2	N 46°05'58" E	21.34'
L3	N 00°19'25" E	15.21'
L4	N 00°19'25" E	15.50'
L5	N 27°27'22" E	8.21'
L6	N 44°38'53" W	20.84'
L7	N 44°40'35" W	17.68'
L8	N 45°50'15" E	21.40'
L9	N 45°19'25" E	17.68'
L10	N 44°38'38" W	21.20'
L11	N 44°48'11" W	17.64'
L12	N 45°11'49" E	17.72'
L13	N 89°40'35" W	9.71'
L14	N 89°40'35" W	2.49'

CURVE	RADIUS	LENGTH	TANGENT	DELTA
C1	48.00'	24.69'	12.63'	29°28'22"
C2	47.00'	68.69'	42.12'	83°44'16"
C3	48.00'	40.40'	21.48'	48°13'18"
C4	48.00'	10.89'	5.47'	12°59'44"
C5	48.00'	29.51'	15.24'	35°13'34"
C6	47.00'	96.74'	78.12'	117°56'14"
C7	48.00'	31.31'	16.24'	37°22'41"
C8	48.00'	20.70'	10.51'	24°42'33"
C9	48.00'	10.61'	5.33'	12°40'08"
C10	47.00'	212.84'	56.55'	259°27'33"
C11	47.00'	66.40'	40.10'	80°56'43"
C12	47.00'	53.00'	29.72'	64°36'36"
C13	47.00'	53.00'	29.72'	64°36'36"
C14	47.00'	40.44'	21.56'	49°17'38"
C15	48.00'	35.25'	18.46'	42°04'52"
C16	48.00'	24.39'	12.46'	29°06'37"
C17	48.00'	12.12'	6.09'	14°28'08"
C18	48.00'	12.27'	6.17'	14°38'29"
C19	47.00'	121.79'	166.51'	148°28'27"
C20	47.00'	57.43'	32.92'	70°00'56"
C21	47.00'	64.36'	36.37'	78°27'31"
C22	48.00'	24.39'	12.46'	29°06'37"
C23	48.00'	7.14'	3.58'	08°31'39"
C24	48.00'	17.24'	8.72'	20°34'58"
C25	48.00'	24.39'	12.46'	29°06'37"
C26	47.00'	121.38'	163.73'	147°58'02"
C27	47.00'	21.82'	11.11'	26°36'11"
C28	47.00'	53.00'	29.72'	64°36'36"
C29	47.00'	46.56'	25.39'	56°45'15"
C30	48.00'	24.39'	12.46'	29°06'37"
C31	14050.00'	235.07'	117.54'	0°57'31"
C32	14050.00'	121.45'	60.72'	0°29'43"
C33	14050.00'	113.62'	56.81'	0°27'48"

