

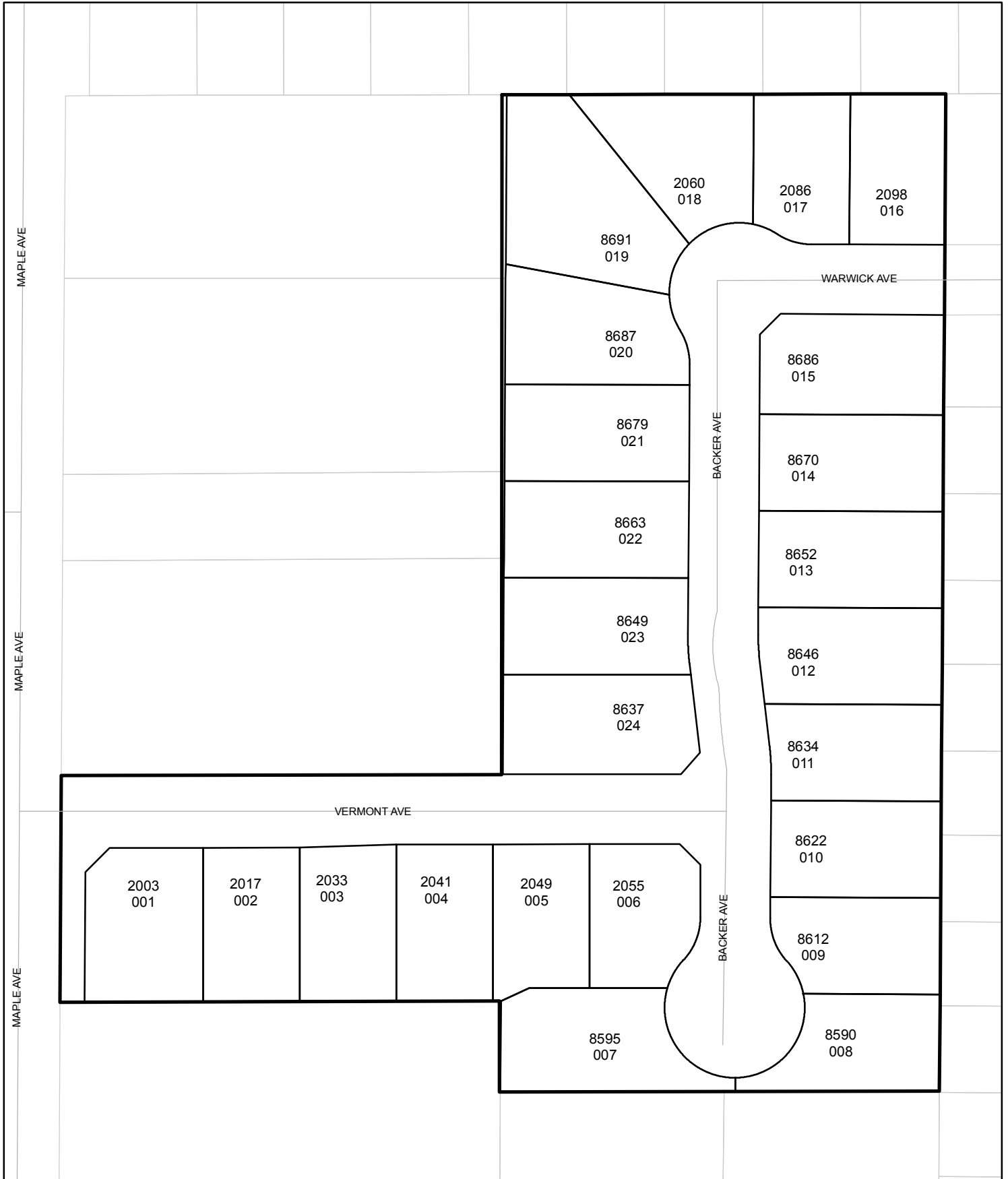

Street Names, Addresses and (Lot Numbers) for T5099

Prepared on Mon Jul 23 22:26:03 2018



TRACT NO. 5099 MAPLE CREEK VILLAGE

IN THE CITY OF FRESNO, FRESNO COUNTY, CALIFORNIA
SURVEYED AND PLATTED IN JUNE 2002
BY YAMABE & HORN ENGINEERING, INC.
CONSISTING OF TWO SHEETS

SHEET 2 OF 2

LEGEND

- EXISTING MONUMENT FOUND AND ACCEPTED OR AS NOTED
- SET 3/4" IRON PIPE, 30" LONG, 4" UP IN 6" DIAMETER X 30" P.C.C. MONUMENT, DOWN 6" BELOW GROUND, TAGGED RICE 30501
- ▼ NOW OFFERED FOR DEDICATION FOR PUBLIC STREET AND PUBLIC UTILITY PURPOSES
- FD FOUND
- O.R.F.C. OFFICIAL RECORDS FRESNO COUNTY
- F.C.R. FRESNO COUNTY RECORDS
- P.U.E. PUBLIC UTILITY EASEMENT
- B.C.M. BRASS CAP MONUMENT
- P.E. PEDESTRIAN EASEMENT OFFERED FOR DEDICATION FOR PUBLIC PURPOSES
- L.E. LANDSCAPE EASEMENT OFFERED FOR DEDICATION FOR PUBLIC PURPOSES
- () DATA PER PARCEL MAP No. 2454, RECORDED IN BOOK 16 OF PARCEL MAPS AT PAGE 100, F.C.R.
- [] DATA PER TRACT No. 4528, RECORDED IN BOOK 55 OF PLATS AT PAGES 71 & 72, F.C.R.
- { } DATA PER TRACT No. 4335, RECORDED IN BOOK 55 OF PLATS, AT PAGES 48 & 49, F.C.R.
- ▲▲▲▲ INDICATES RELINQUISHMENT OF DIRECT VEHICULAR ACCESS RIGHTS
- BLUE BORDER INDICATES LIMITS OF THIS SUBDIVISION

BASIS OF BEARINGS

THE WEST LINE OF THE NORTHWEST QUARTER OF SECTION 25, TOWNSHIP 12 SOUTH, RANGE 20 EAST, TAKEN AS NORTH, PER PARCEL MAP No. 2454, RECORDED IN BOOK 16 OF PARCEL MAPS, AT PAGE 100, F.C.R.

NOTE:

SET 3/4" IRON PIPE, DOWN 0.5', TAGGED "RICE 30501" AT ALL LOT CORNERS, UNLESS OTHERWISE NOTED

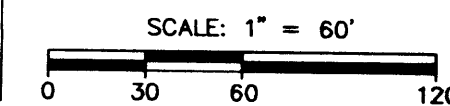

| CURVE TABLE | | | |
|-------------|---------|---------|------------|
| CURVE | RADIUS | LENGTH | DELTA |
| C1 | 45.00' | 33.41' | 42°32'13" |
| C2 | 45.00' | 33.41' | 42°32'13" |
| C3 | 50.00' | 23.18' | 26°33'39" |
| C4 | 50.00' | 26.84' | 30°45'13" |
| C5 | 50.00' | 32.89' | 106°26'54" |
| C6 | 50.00' | 88.41' | 101°18'40" |
| C7 | 50.00' | 231.32' | 265°04'26" |
| C8 | 45.00' | 25.63' | 32°38'13" |
| C9 | 50.00' | 19.27' | 22°04'47" |
| C10 | 50.00' | 50.46' | 57°49'12" |
| C11 | 50.00' | 40.00' | 45°50'12" |
| C12 | 45.00' | 25.63' | 32°38'13" |
| C13 | 50.00' | 25.78' | 29°32'40" |
| C14 | 50.00' | 135.51' | 155°16'52" |
| C15 | 175.00' | 21.31' | 6°58'38" |
| C16 | 150.00' | 18.27' | 6°58'38" |
| C18 | 175.00' | 21.31' | 6°58'38" |
| C19 | 125.00' | 15.22' | 6°58'38" |

| LINE TABLE | | |
|------------|-------------|----------|
| LINE | BEARING | DISTANCE |
| L1 | N44°46'01"E | 16.53' |
| L2 | N45°13'46"W | 20.74' |
| L3 | S65°22'38"W | 21.96' |
| L4 | S89°32'56"W | 5.73' |
| L5 | S00°27'55"E | 10.00' |
| L6 | N45°00'39"E | 20.77' |
| L7 | N41°16'41"E | 20.56' |
| L8 | N06°58'12"W | 8.33' |

| RADIAL TABLE | |
|--------------|-------------|
| LINE | BEARING |
| R8 | N00°00'52"E |
| R9 | N32°39'05"E |
| R10 | S10°34'18"W |
| R11 | S47°14'55"E |
| R12 | N86°54'54"E |
| R13 | N57°22'13"E |
| R14 | N89°59'34"W |
| R15 | N89°59'34"W |
| R16 | N47°27'21"W |
| R17 | S74°01'01"E |
| R18 | N00°27'55"W |
| R19 | S78°13'26"W |
| R20 | N47°28'13"E |
| R21 | S89°59'34"E |
| R22 | S89°59'34"E |
| R23 | N83°01'48"E |
| R24 | S89°59'34"E |
| R25 | N83°01'48"E |
| R26 | S83°01'48"W |
| R27 | N89°59'34"W |

OFFICIAL ADDRESS NUMBERS
WHICH APPEARS ON THIS PAGE MUST BE INSTALLED
BEFORE FINAL INSPECTION AS PER SECTION 12-1304
F.M.S. (MINIMUM SIZE 3" HIGH WITH 1/4" STROKE)
ISSUED BY *Paul Bernal* DATE *6/18/03*

