

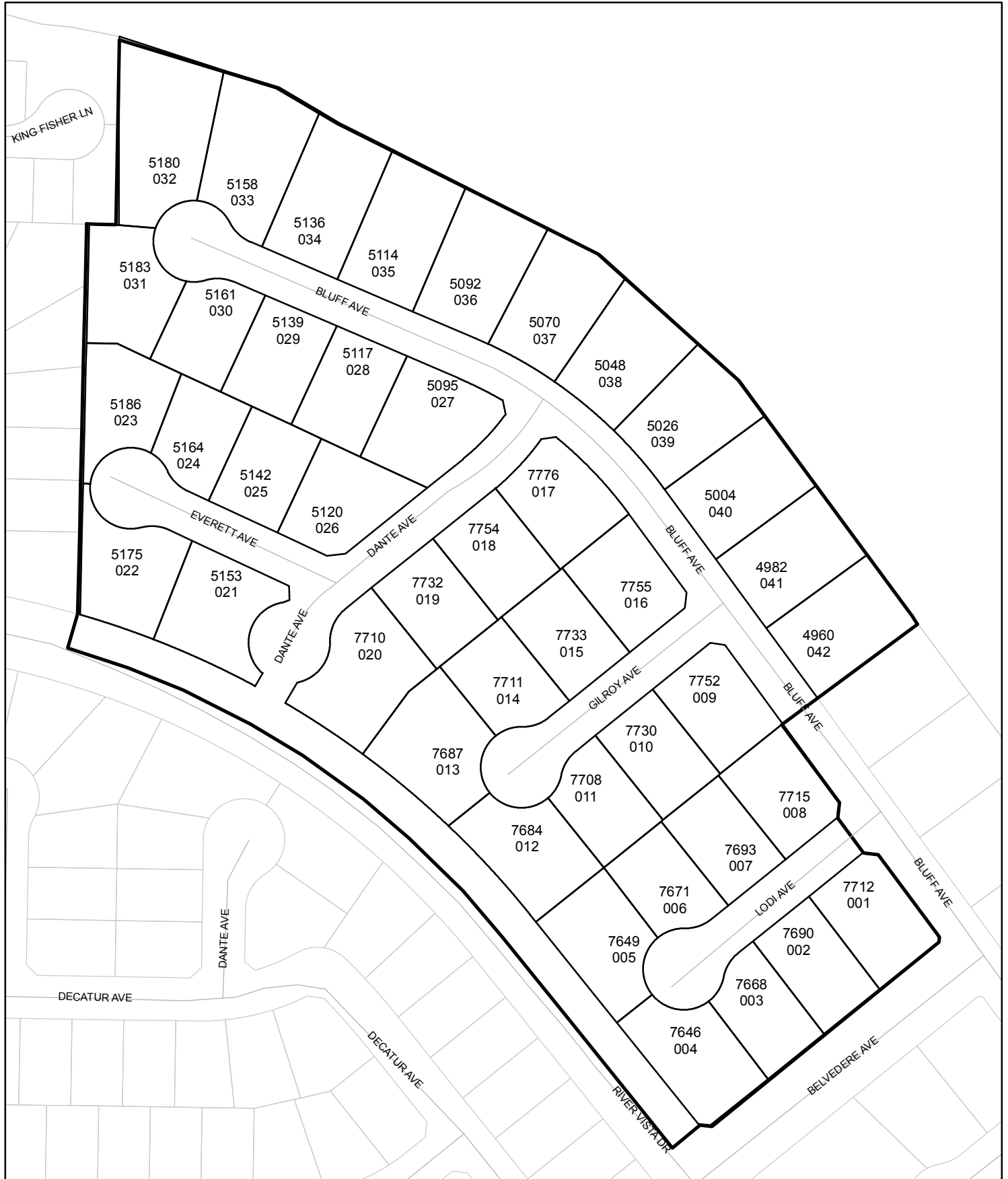

Street Names, Addresses and (Lot Numbers) for T5086

Prepared on Thu Nov 16 22:55:29 2017



TRACT NO. 5086

PHASE II OF TENTATIVE TRACT NO. 4723
 IN THE CITY OF FRESNO, COUNTY OF FRESNO, STATE OF CALIFORNIA
 SURVEYED AND PLATTED IN APRIL 2002, BY GARY G. GIANNETTA
 SHEET TWO OF TWO SHEETS

LEGEND:

- MONUMENT FOUND AND ACCEPTED AS NOTED
- SET 3/4" IRON PIPE, 30" LONG, 6" DOWN BELOW GROUND, TAGGED R.C.E. 26996
- ⊙ SET 3/4" IRON PIPE, 30" LONG, 4" UP IN 6" DIAMETER x 30" P.C.C. MONUMENT, DOWN 6" BELOW GROUND, TAGGED R.C.E. 26996
- ▲ NOW OFFERED FOR DEDICATION FOR PUBLIC STREET PURPOSES
- △ PREVIOUSLY DEEDED FOR PUBLIC STREET PURPOSES OCTOBER 23, 1996 AS DOC. NO. 96142854, O.R.F.C.
- △ PREVIOUSLY DEEDED FOR PUBLIC STREET PURPOSES FEBRUARY 12, 1996, DOC. NO. 96018389, O.R.F.C.
- △ PREVIOUSLY DEEDED FOR PUBLIC STREET PURPOSES MARCH 28, 1996 AS DOC. NO. 96039849, O.R.F.C.
- △ PREVIOUSLY DEEDED FOR PUBLIC STREET PURPOSES AS PER MAP OF TRACT NO. 4723, RECORDED IN VOL. 65, PAGES 62 AND 63 OF PLATS, F.C.R.
- △ PACIFIC GAS AND ELECTRIC COMPANY EASEMENT, RECORDED OCTOBER 11, 2002, AS DOC. NO. 2002-0179542, F.C.R.
- ▲▲▲▲ INDICATES RELINQUISHMENT OF DIRECT ACCESS RIGHTS
- () RECORD DATA AS PER TRACT NO. 4723, RECORDED IN VOLUME 65, PAGES 62 AND 63 OF PLATS, F.C.R.
- (()) RECORD DATA AS PER McCAFFREY COMMUNITY NO. 5, TRACT NO. 4664, RECORDED IN VOLUME 59, PAGES 59 AND 60 OF PLATS, F.C.R.
- [] RECORD DATA AS PER McCAFFREY COMMUNITY NO. 7, TRACT NO. 4768, RECORDED IN VOLUME 60, PAGES 45, 46 AND 47 OF PLATS, F.C.R.
- PM 5284 PARCEL MAP NO. 5284, RECORDED IN BOOK 35, PAGES 85 AND 86 OF PARCEL MAPS, F.C.R.
- TR 4664 McCAFFREY COMMUNITY NO. 5, TRACT NO. 4664, RECORDED IN VOLUME 59, PAGES 59 AND 60 OF PLATS, F.C.R.
- TR 4768 McCAFFREY COMMUNITY NO. 7, TRACT NO. 4768, RECORDED IN VOLUME 60, PAGES 45, 46 & 47 OF PLATS, F.C.R.
- CALC CALCULATED FROM RECORD DATA
- F.C.R. FRESNO COUNTY RECORDS
- LE LANDSCAPE EASEMENT NOW OFFERED FOR DEDICATION FOR PUBLIC USE
- PE PEDESTRIAN EASEMENT NOW OFFERED FOR DEDICATION FOR PUBLIC USE
- PUE PUBLIC UTILITY EASEMENT NOW OFFERED FOR DEDICATION FOR PUBLIC USE
- (R) DENOTES RADIAL BEARING TO CURVE
- BLUE BORDER INDICATES THE LIMITS OF THIS SUBDIVISION

SCALE: 1" = 100'

BASIS OF BEARINGS :

THE MOST NORTHEASTERLY BOUNDARY OF TRACT NO. 4723, RECORDED IN VOLUME 65, PAGES 62 AND 63 OF PLATS, FRESNO COUNTY RECORDS TAKEN AS BEARING NORTH 36°38'34" WEST, AS PER SAID MAP.

| LINE | DIRECTION | DISTANCE |
|------|---------------|----------|
| L1 | N 85°49'48" W | 42.43' |
| L2 | N 88°57'19" W | 35.16' |
| L3 | N 88°57'19" W | 6.00' |
| L4 | N 24°37'23" E | 5.00' |
| L5 | N 29°19'16" E | 17.13' |
| L6 | N 29°19'16" E | 27.43' |
| L7 | N 00°55'05" W | 16.13' |
| L8 | N 82°42'55" E | 21.23' |
| L9 | N 12°29'08" W | 17.03' |
| L10 | N 81°15'31" E | 17.13' |
| L11 | N 07°08'20" E | 18.07' |
| L12 | N 82°51'40" W | 17.28' |
| L13 | S 50°51'03" W | 61.27' |
| L14 | N 39°08'57" W | 4.00' |
| L15 | S 50°51'03" W | 52.43' |
| L16 | N 34°13'38" E | 30.23' |

| RADIAL | DIRECTION |
|--------|---------------|
| R1 | N 62°37'01" E |
| R2 | N 04°07'26" E |
| R3 | N 71°21'51" W |
| R4 | S 10°13'29" W |
| R5 | S 16°57'31" E |
| R6 | N 24°34'48" E |
| R7 | N 29°41'52" E |
| R8 | N 38°44'53" E |
| R9 | S 54°07'13" E |
| R10 | S 54°22'31" E |
| R11 | S 19°42'44" E |
| R12 | N 24°11'13" E |
| R13 | N 59°23'23" E |
| R14 | S 40°35'56" E |
| R15 | S 26°34'57" E |
| R16 | N 13°09'45" W |
| R17 | S 40°43'28" W |
| R18 | N 27°56'42" E |
| R19 | N 30°08'49" E |
| R20 | S 11°28'24" E |
| R21 | N 88°57'16" E |
| R22 | N 61°00'22" W |
| R23 | N 43°10'19" E |
| R24 | N 00°38'19" E |
| R25 | S 78°56'13" E |
| R26 | S 41°10'29" E |
| R27 | N 03°17'48" W |
| R28 | N 37°43'58" W |
| R29 | S 37°43'58" E |
| R30 | S 82°34'15" E |

| CURVE | RADIUS | LENGTH | TANGENT | DELTA |
|-------|----------|---------|---------|------------|
| C1 | 48.00' | 33.33' | 17.37' | 39°47'16" |
| C2 | 47.00' | 212.93' | 56.44' | 259°34'32" |
| C3 | 47.00' | 47.98' | 26.32' | 58°29'35" |
| C4 | 47.00' | 61.92' | 36.38' | 75°29'17" |
| C5 | 47.00' | 80.73' | 54.46' | 98°24'40" |
| C6 | 47.00' | 22.30' | 11.36' | 27°11'00" |
| C7 | 475.00' | 56.94' | 28.51' | 06°52'07" |
| C8 | 525.00' | 280.37' | 143.61' | 30°35'52" |
| C9 | 525.00' | 16.04' | 8.02' | 01°45'03" |
| C10 | 525.00' | 88.40' | 44.30' | 09°38'50" |
| C11 | 525.00' | 88.40' | 44.30' | 09°38'50" |
| C12 | 525.00' | 87.53' | 43.87' | 09°33'09" |
| C13 | 500.00' | 267.02' | 136.77' | 30°35'52" |
| C14 | 500.00' | 49.47' | 24.74' | 11°23'53" |
| C15 | 500.00' | 167.55' | 84.57' | 19°11'59" |
| C16 | 475.00' | 121.69' | 61.18' | 14°40'44" |
| C17 | 275.00' | 71.86' | 36.13' | 14°58'16" |
| C18 | 300.00' | 87.04' | 43.83' | 16°37'25" |
| C19 | 325.00' | 86.37' | 43.44' | 15°13'34" |
| C20 | 325.00' | 78.14' | 39.26' | 13°46'35" |
| C21 | 325.00' | 8.22' | 4.11' | 01°26'59" |
| C22 | 48.00' | 29.16' | 15.05' | 34°48'35" |
| C23 | 47.00' | 212.54' | 56.91' | 259°06'06" |
| C24 | 47.00' | 28.88' | 14.91' | 35°12'09" |
| C25 | 47.00' | 92.81' | 71.20' | 11°30'32" |
| C26 | 47.00' | 90.85' | 68.08' | 11°04'25" |
| C27 | 48.00' | 37.11' | 19.54' | 44°17'32" |
| C28 | 48.00' | 11.24' | 5.65' | 13°25'12" |
| C29 | 47.00' | 103.45' | 92.47' | 126°06'45" |
| C30 | 200.00' | 76.30' | 38.62' | 21°51'25" |
| C31 | 47.00' | 65.27' | 39.14' | 79°34'19" |
| C32 | 48.00' | 43.48' | 23.36' | 51°53'47" |
| C33 | 48.00' | 33.33' | 17.37' | 39°47'16" |
| C34 | 47.00' | 212.93' | 56.44' | 259°34'32" |
| C35 | 47.00' | 32.64' | 17.01' | 39°47'16" |
| C36 | 47.00' | 73.83' | 47.00' | 90°00'00" |
| C37 | 47.00' | 75.49' | 48.69' | 92°01'32" |
| C38 | 47.00' | 30.98' | 16.07' | 37°45'44" |
| C39 | 48.00' | 30.04' | 15.53' | 35°51'09" |
| C40 | 47.00' | 212.68' | 56.74' | 259°16'27" |
| C41 | 47.00' | 28.25' | 14.57' | 34°26'10" |
| C42 | 47.00' | 74.99' | 48.18' | 91°24'59" |
| C43 | 47.00' | 72.67' | 45.85' | 88°35'01" |
| C44 | 47.00' | 36.78' | 19.39' | 44°50'17" |
| C45 | 48.00' | 36.38' | 19.11' | 43°25'18" |
| C46 | 1041.00' | 219.29' | 110.06' | 12°04'11" |
| C47 | 1041.00' | 95.22' | 47.64' | 05°14'27" |
| C48 | 1041.00' | 124.07' | 62.11' | 6°49'44" |
| C49 | 1041.00' | 376.08' | 190.11' | 20°41'56" |
| C50 | 1041.00' | 107.12' | 53.61' | 5°53'45" |
| C51 | 1041.00' | 129.53' | 64.85' | 7°07'45" |
| C52 | 1041.00' | 139.43' | 69.82' | 7°40'26" |

3/4" IRON PIPE, 5" UP, NO TAG, AS BEING AN ANGLE POINT ON THE TOP OF BLUFF OF THE SAN JOAQUIN RIVER AS PER PM 5284

3/4" IRON PIPE, 2" UP, NO TAG, AS BEING AN ANGLE POINT ON THE TOP OF BLUFF OF THE SAN JOAQUIN RIVER AS PER PM 5284

3/4" IRON PIPE, 6" UP, NO TAG, AS BEING AN ANGLE POINT ON THE TOP OF BLUFF OF THE SAN JOAQUIN RIVER AS PER PM 5284

3/4" IRON PIPE, 10" DOWN, NO TAG, AS BEING AN ANGLE POINT ON THE TOP OF BLUFF OF THE SAN JOAQUIN RIVER AS PER PM 5284

3/4" IRON PIPE, 7" DOWN, TAGGED RCE 26996, AS BEING THE NORTHEAST CORNER OF LOT 18 OF TR 4768

3/4" IRON PIPE, 5" DOWN, IN CONCRETE, TAGGED RCE 26996, AS BEING THE SOUTHWEST CORNER OF LOT 23 OF TR 4768

3/4" IRON PIPE, 6" DOWN, IN CONCRETE, TAGGED RCE 26996, AS BEING THE MOST NORTHERLY CORNER OF LOT 32 OF TRACT NO. 4723

BRASS TAG, IN TOP OF RETAINING WALL TAGGED RCE 26996, AS BEING THE MOST EASTERLY NORTHEAST CORNER OF LOT 29 OF TRACT NO. 4723

3/4" IRON PIPE, 6" DOWN, TAGGED RCE 26996, AS BEING THE MOST NORTHERLY CORNER OF LOT 20

3/4" IRON PIPE, 6" DOWN, TAGGED RCE 26996 ACCEPTED AS BEING THE MOST NORTHERLY CORNER OF LOT 45 OF TR 4664

3/4" IRON PIPE, 6" DOWN, TAGGED RCE 26996 ACCEPTED AS BEING THE MOST NORTHERLY CORNER OF LOT 43 OF TR 4664

3/4" IRON PIPE, 6" DOWN, TAGGED RCE 26996 ACCEPTED AS BEING THE MOST NORTHERLY CORNER OF LOT 40 OF TR 4664

3/4" IRON PIPE, 6" DOWN, TAGGED RCE 26996, AS BEING THE MOST SOUTHERLY CORNER CUT-OFF OF LOT 3 OF TRACT NO. 4723

NOTE:
 1. SET 3/4" IRON PIPE, 6" DOWN, TAGGED RCE 26996 AT ALL LOT CORNERS

